

Leve di ricambio per valvole e rubinetti a sfera

Spare levers for ball valves and drain cocks



Leva standard in acciaio imbutita

Standard drawn steel lever

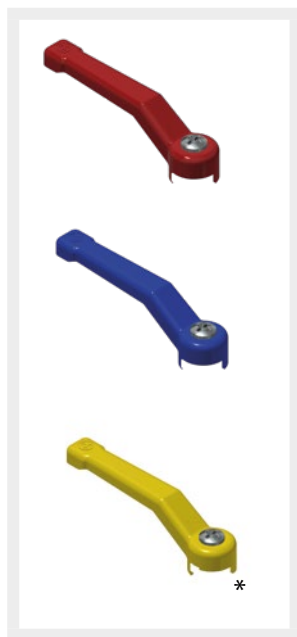

* Leva in colore giallo disponibile solo per valvole a sfera gas.

* Yellow lever available only for gas ball valves.

Serie valvola Valve series	Attacchi Connections	Codici leve Levers codes			
		●	●	●	
186	1/2"	66830	67185	-	
	3/4"	66830	67185	-	
	1"	66830	67185	-	
178/182	3/8"	66830	67185	-	
	1/2"	66830	67185	-	
	3/4"	66830	67185	-	
	1"	66835	67180	-	
	1" 1/4	66835	67180	-	
	1" 1/2	66825	66820	-	
300	2"	66825	66820	-	
	3/8"	66830	67185	-	
	1/2"	66830	67185	-	
	3/4"	66830	67185	-	
	1"	66835	67180	-	
	1" 1/4	66835	67180	-	
	1" 1/2	66825	66820	-	
	2"	66825	66820	-	
370 / 372	2" 1/2	66825	66820	-	
	3"	67355	-	-	
	3/8"	66830	67185	-	
	1/2"	66830	67185	-	
	3/4"	66830	67185	-	
	1"	66835	67180	-	
	1" 1/4	66835	67180	-	
374	1" 1/2	66825	66820	-	
	2"	66825	66820	-	
	1/2"	66830	67185	-	
380 / 382	3/4"	66830	67185	-	
	1"	66835	67180	-	
	1" 1/4	66835	67180	66840	
	1" 1/2	66825	66820	67655	
	2"	66825	66820	67655	
	2" 1/2	67355	-	-	
	3"	67355	-	-	
	4"	67355	-	-	
	462	1/2"	66830	67185	-
		3/4"	66830	67185	-
		1"	66835	67180	-
376 / 377	1/2"	66830	67185	-	
	3/4"	66830	67185	-	
	1"	66835	67180	-	
	1" 1/4	66835	67180	-	
	1" 1/2	66835	67180	-	
	2"	66825	66820	-	

Manopola in alluminio

Aluminium knob



* Leva in colore giallo disponibile solo per valvole a sfera gas.

* Yellow lever available only for gas ball valves.

Serie valvola Valve series	Attacchi Connections	Codici manopole Knob codes			
		●	●	●	●
186	1/2"	66685	66775	-	66770
	3/4"	66685	66775	-	66770
	1"	66685	66775	-	66770
352 / 353	1/2"	66685	66775	-	66770
	3/4"	66685	66775	-	66770
362 / 363	1/2"	66685	66775	-	66770
	3/4"	66685	66775	-	66770
	1"	66690	66695	-	-
300	3/8"	66685	66775	-	66770
	1/2"	66685	66775	-	66770
	3/4"	66685	66775	-	66770
	1"	66690	66695	-	-
	1" 1/4	66690	66695	-	-
	1" 1/2	-	-	-	-
	2"	-	-	-	-
2" 1/2	-	-	-	-	
370 / 372	3/8"	66685	66775	-	66770
	1/2"	66685	66775	-	66770
	3/4"	66685	66775	-	66770
	1"	66690	66695	-	-
	1" 1/4	66690	66695	-	-
	1" 1/2	-	-	-	-
374	2"	-	-	-	-
	1/2"	66685	66775	-	66770
	3/4"	66685	66775	-	66770
380 / 382	1"	66690	66695	-	-
	1/4"	66685	66775	67190	66770
	3/8"	66685	66775	67190	66770
	1/2"	66685	66775	67190	66770
	3/4"	66685	66775	67190	66770
	1"	66690	66695	69270	-
462	1" 1/4	68010	68005	69270	-
	1/2"	66685	66775	-	66770
	3/4"	66685	66775	-	66770
376 / 377	1"	66690	66695	-	-
	1/2"	66685	66775	-	66770
	3/4"	66685	66775	-	66770
376 / 377	1"	66690	66695	-	-

Leva piatta in acciaio

Steel flat lever



Serie valvola Valve series	Attacchi Connections	Codici leve Levers codes
186	1/2"	67485
	3/4"	67485
	1"	67485
300	3/8"	67485
	1/2"	67485
	3/4"	67485
	1"	68570
	1" 1/4	68570
	1" 1/2	68960
	2"	69030
	2" 1/2	-
370 / 372	3/8"	67485
	1/2"	67485
	3/4"	67485
	1"	68570
	1" 1/4	68570
	1" 1/2	68960
	2"	68960
374	1/2"	67485
	3/4"	67485
	1"	68570
380 / 382	1/4"	67485
	3/8"	67485
	1/2"	67485
	3/4"	67485
	1"	68570
	1" 1/4	68570
	1" 1/2	68960
462	2"	69030
	1/2"	67485
	3/4"	67485
376 / 377	1"	68570
	1/2"	67485
	3/4"	67485
	1"	68570
	1" 1/4	68570
	1" 1/2	68570

Leva piatta in acciaio inox AISI 430

AISI 430 stainless steel flat lever



Serie valvola Valve series	Attacchi Connections	Codici leve Levers codes
186	1/2"	67905
	3/4"	67905
	1"	67905
300	3/8"	67905
	1/2"	67905
	3/4"	67905
	1"	67480
	1" 1/4	67480
	1" 1/2	67490
	2"	68965
370 / 372	3/8"	67905
	1/2"	67905
	3/4"	67905
	1"	67480
	1" 1/4	67480
	1" 1/2	67490
374	2"	67490
	1/2"	67905
	3/4"	67905
380 / 382	1"	67480
	1/4"	67905
	3/8"	67905
	1/2"	67905
	3/4"	67905
	1"	67480
	1" 1/4	67480
	1" 1/2	67490
462	2"	68965
	1/2"	67905
	3/4"	67905
376 / 377	1"	67480
	1/2"	67905
	3/4"	67905
	1"	67480
	1" 1/4	67480
	1" 1/2	67480

Leva in alluminio
Aluminium lever



Serie valvola Valve series	Attacchi Connections	Codici leve Levers codes
		●
186	1/2"	68970
	3/4"	68970
	1"	68970
181	3/8"	67690
	1/2"	67690
	3/4"	67690
	1"	67695
	1" 1/4	67695
	1" 1/2"	68950
	2"	68950
178/182	3/8"	68970
	1/2"	68970
	3/4"	68970
	1"	68980
	1" 1/4	68980
	1" 1/2	69035
	2"	69035
300	3/8"	68970
	1/2"	68970
	3/4"	68970
	1"	68980
	1" 1/4	68980
	1" 1/2	69035
	2"	69035
	2" 1/2	69035
370 / 372	3/8"	68970
	1/2"	68970
	3/4"	68970
	1"	68980
	1" 1/4	68980
	1" 1/2	69035
374	2"	69035
	1/2"	68970
	3/4"	68970
380 / 382	1"	68980
	1" 1/4	68980
	1" 1/2	69035
	2"	69035
	1/4"	68970
	3/8"	68970
	1/2"	68970
	3/4"	68970
462	1"	68980
	1/2"	68970
	3/4"	68970
376 / 377	1"	68980
	1" 1/4	68980
	1" 1/2	69035
	2"	69035
	1/2"	68970

Farfalla in ottone o nichelata

Brass or nickel-plated butterfly handle

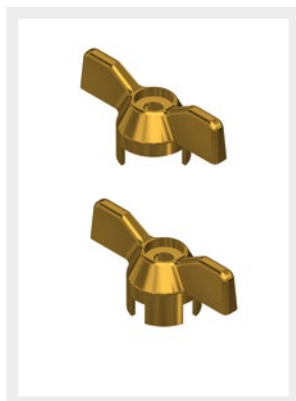

Serie valvola Valve series	Attacchi Connections	OTTONE/BRASS Codici/ Codes		NICHELATA/NICKEL-PLATED Codici/ Codes	
		blocco 3 alette blocking 3 flaps	aperto/chiuso 2 alette open/close 2 flaps	blocco 3 alette blocking 3 flaps	aperto/chiuso 2 alette open/close 2 flaps
186	1/2"	69005	69005/2	69005N	69005N/2
	3/4"	69005	69005/2	69005N	69005N/2
	1"	69005	69005/2	69005N	69005N/2
352 / 353	1/2"	69005	69005/2	69005N	69005N/2
	3/4"	69005	69005/2	69005N	69005N/2
362 / 363	1/2"	69005	69005/2	69005N	69005N/2
	3/4"	69005	69005/2	69005N	69005N/2
300	3/8"	69005	69005/2	69005N	69005N/2
	1/2"	69005	69005/2	69005N	69005N/2
	3/4"	69005	69005/2	69005N	69005N/2
370 / 372	3/8"	69005	69005/2	69005N	69005N/2
	1/2"	69005	69005/2	69005N	69005N/2
	3/4"	69005	69005/2	69005N	69005N/2
374	1/2"	69005	69005/2	69005N	69005N/2
	3/4"	69005	69005/2	69005N	69005N/2
380 / 382	1/4"	69005	69005/2	69005N	69005N/2
	3/8"	69005	69005/2	69005N	69005N/2
	1/2"	69005	69005/2	69005N	69005N/2
	3/4"	69005	69005/2	69005N	69005N/2
462	1/2"	69005	69005/2	69005N	69005N/2
	3/4"	69005	69005/2	69005N	69005N/2
376 / 377	1/2"	69005	69005/2	69005N	69005N/2
	3/4"	69005	69005/2	69005N	69005N/2

Quadro in ottone

Lockable square head



Serie valvola Valve series	Attacchi Connections	Codici/Codes	
		blocco 3 alette blocking 3 flaps	aperto/chiuso 2 alette open/close 2 flaps
186	1/2"	R2605	R2605/2
	3/4"	R2605	R2605/2
	1"	R2605	R2605/2
352 / 353	1/2"	R2605	R2605/2
	3/4"	R2605	R2605/2
362 / 363	1/2"	R2605	R2605/2
	3/4"	R2605	R2605/2
	1"	R2606/3	R2606/1
300	3/8"	R2605	R2605/2
	1/2"	R2605	R2605/2
	3/4"	R2605	R2605/2
	1"	R2606/3	R2606/1
370 / 372	1" 1/4	R2606/3	R2606/1
	3/8"	R2605	R2605/2
	1/2"	R2605	R2605/2
	3/4"	R2605	R2605/2
	1"	R2606/3	R2606/1
374	1" 1/4	R2606/3	R2606/1
	1/2"	R2605	R2605/2
	3/4"	R2605	R2605/2
	1"	R2606/3	R2606/1
380 / 382	1/4"	R2605	R2605/2
	3/8"	R2605	R2605/2
	1/2"	R2605	R2605/2
	3/4"	R2605	R2605/2
	1"	R2606/3	R2606/1
376 / 377	1" 1/4	R2606/3	R2606/1
	1/2"	R2605	R2605/2
	3/4"	R2605	R2605/2
	1"	R2606/3	R2606/1
	1" 1/4	R2606/3	R2606/1
	1" 1/2	R2606/3	R2606/1

293

Valvole di non ritorno

Check valves

PN10



- Adate all'installazione in impianti idraulici (industriali ed agricoli), impianti di riscaldamento (a radiatori e a pannelli), centrali termiche (caldaie murali, caldaie a basamento, caldaie a legna e pompe di calore).
- Suitable for installation in plumbing systems (industrial and agricultural), heating systems, (radiators and panels) thermal power plants (wall-mounted boilers, floor-standing boilers, wood boilers, and heat pumps).

- Temperatura di esercizio: -20°C / +100°C.
- Filettatura ISO 228-1.

- Working temperature: -20°C / +100°C.
- Thread ISO 228-1.

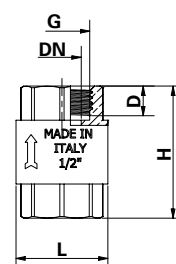

Attacchi Connections	Codice prodotto Product code	PN	DN	D mm	H mm	L mm
3/8"	293C3/8	12	15	11	45	31
1/2"	293D1/2	12	15	11	45	31
3/4"	293E3/4	12	20	11	50	39
1"	293F001	12	25	14	58	47
1" 1/4	293G11/4	10	32	17	64	56
1" 1/2	293H11/2	10	40	15	69	66
2"	293I002	10	50	17	77	83
2" 1/2	293L21/2	8	65	17	87	107
3"	293M003	8	80	21	102	109
4"	293N004	8	100	21	112	140



Per creare una valvola di fondo, è possibile installare:
 - filtri con filetto in ottone, serie 298
 - filtri con filetto in nylon, serie 299.

To create a foot valve, you can install:
 - filters with brass connection, 298 series
 - filters with nylon connection, 299 series

294

Valvole di non ritorno

Check valves

PN25

MADE IN ITALY

- Adatte all'installazione in impianti idraulici (industriali ed agricoli), impianti di riscaldamento (a radiatori e a pannelli), centrali termiche (caldaie murali, caldaie a basamento, caldaie a legna e pompe di calore).
- Suitable for installation in plumbing systems (industrial and agricultural), heating systems, (radiators and panels) thermal power plants (wall-mounted boilers, floor-standing boilers, wood boilers, and heat pumps).

- Temperatura di esercizio: -20°C / +100°C.
- Filettatura ISO 228-1.
- Working temperature: -20°C / +100°C.
- Thread ISO 228-1.

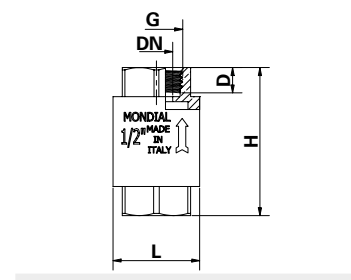

ACCESSORI ACCESSORIES

Attacchi Connections	Codice prodotto Product code	PN	DN	D mm	H mm	L mm
1/2"	294D1/2	25	15	11	58,5	34,5
3/4"	294E3/4	25	20	13	65	41,5
1"	294F001	25	25	16	74,5	48
1" 1/4	294G11/4	18	32	18	83	60,5
1" 1/2	294H11/2	18	40	21	93	71
2"	294I002	18	50	21	101	87



Per creare una valvola di fondo, è possibile installare:
 - filtri con filetto in ottone, serie 298
 - filtri con filetto in nylon, serie 299.

To create a foot valve, you can install:
 - filters with brass connection, 298 series
 - filters with nylon connection, 299 series

473

Filtro a Y

Y filter

PN20



- Adatti all'installazione in impianti idraulici, di riscaldamento, di condizionamento e aria compressa
- Suitable for installation in plumbing, heating, air conditioning and compressed air systems.

- Temperatura di lavoro: 0 °C / + 100 °C.
- Direzione del flusso: indicazione della freccia.
- Filtro in acciaio inox AISI 304: 500 micron da 3/8" a 2" e 3".
- 1000 micron per 2" 1/2 e 4.

- Working temperature: 0°C / +100°C.
- Flow direction: arrow indication.
- Strainer in stainless steel AISI 304: 500 micron from 3/8" to 2" and size 3".
- 1000 micron for 2"1/2 and 4.

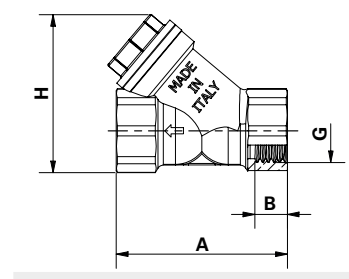

Attacchi Connections	Codice prodotto Product code	PN	A mm	B mm	H mm
3/8"	473C3/8	20	49	10	45
1/2"	473D1/2	20	55	12	50
3/4"	473E3/4	20	64	13	59
1"	473F001	20	76	14	70
1"1/4	473G11/4	20	96	16	90
1"1/2	473H11/2	20	101	18	102
2"	473I002	20	120	18	120
2" 1/2	473L21/2	16	149	23	150
3"	473M003	16	168	25	170
4"	473N004	16	216	28	225

298

Filtri con filetto in ottone per valvole serie 293-294

Filters with brass connection for 293-294 valves series

- Filtro in acciaio inox con raccordo in ottone.
- *Stainless steel filter with brass fitting.*

- Temperatura di esercizio: 0°C / +150°C (escluso gelo).
- Filettatura ISO 228-1.

- *Working temperature: 0°C / +150°C (excluding frost).*
- *Thread ISO 228-1.*

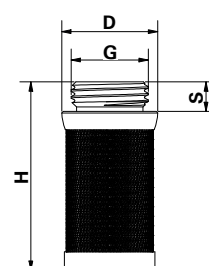

Attacchi Connections	Codice prodotto Product code	H mm	D mm	S mm	Rete Net
3/8"	298C3/8	50	22	7	A
1/2"	298D1/2	49	26	6	A
3/4"	298E3/4	55	32	6,5	A
1"	298F001	63	40	9	A
1" 1/4	298G11/4	69	48	10	A
1" 1/2	298H11/2	79	54	10	A
2"	298I002	94	65	10,3	A
2" 1/2	298L21/2	95	85	11,5	A
3"	298M003	111	99	11,5	A
4"	298N004	128	122	12	A

299

Filtri con filetto in nylon per valvole serie 293-294

Filters with nylon connection for 293-294 valves series



- Filtro in acciaio inox con raccordo in nylon.
- *Stainless steel filter with nylon fitting.*

- Temperatura di esercizio: 0°C / +95°C (escluso gelo).
- Filettatura ISO 228-1.

- *Working temperature: 0°C / +95°C (excluding frost).*
- *Thread ISO 228-1.*

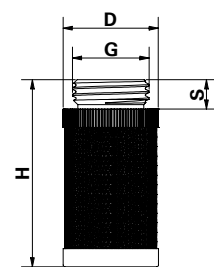

Attacchi Connections	Codice prodotto Product code	H	D	S	Rete
3/8"	299C3/8	50	23	7	B
1/2"	299D1/2	50,5	26	8	B
3/4"	299E3/4	58	32	9	B
1"	299F001	63	41	10	B
1" 1/4	299G11/4	69	49	11	B
1" 1/2	299H11/2	79	55	11	B
2"	299I002	96,5	67	12	B
2" 1/2	299L21/2	97	86	13	B
3"	299M003	112	99	14,5	B
4"	299N004	129	122	14	B

836

Guscio di isolamento

Insulation shell

- Guscio di coibentazione espanso in PE
- *Expanded PE insulation shell*



Attacchi Connections	Codice prodotto Product code
1/2"	836D1/2
3/4"	836E3/4
1"	836F001